

J:\1717-01-0022-Fouraker Subdivision Design\Drawings\1717-0022 PRELIM SITE.Dwg Printed: Jun 23, 2017 - 11:29am Printed By: Justin

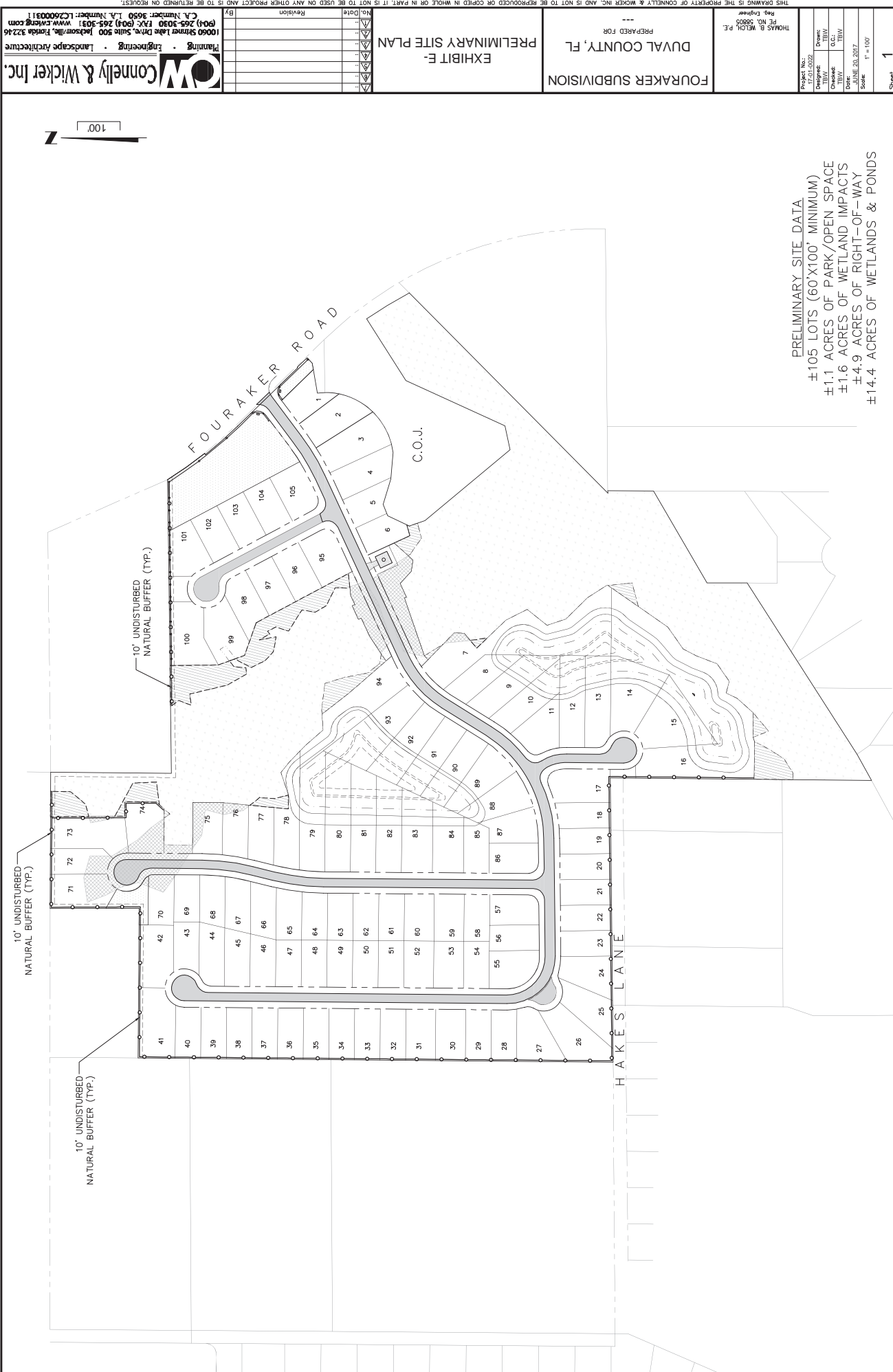

PRELIMINARY SITE DATA
 ±105 LOTS (60'X100' MINIMUM)
 ±1.1 ACRES OF PARK/OPEN SPACE
 ±1.6 ACRES OF WETLAND IMPACTS
 ±4.9 ACRES OF RIGHT-OF-WAY
 ±14.4 ACRES OF WETLANDS & PONDS

OW
Connelly & Wicker Inc.
 Planning • Engineering • Landscape Architecture
 10660 Shimmer Lake Drive, Suite 500 Jacksonville, Florida 32246
 (904) 265-3030 FAX: (904) 265-3031 www.cweng.com
 C.A. Number: 3690 I.A. Number: LC26000311

No.	Date	Revision	By

EXHIBIT E-
 PRELIMINARY SITE PLAN

FOURAKER SUBDIVISION
 PREPARED FOR

THOMAS S. WELCH, P.E.
 Reg. Engineer
 FE No. 58805

Project No.	17-01-0022
Drawn:	DLB/ST
Checked:	TBW
Date:	06/20/2017
Scale:	1" = 100'